

## MPPS SERIE

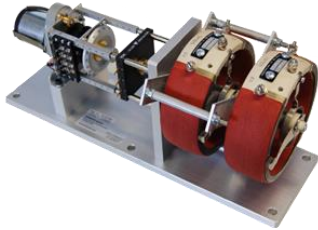

### For control unit, switching programs

- ➔ High power rating 20W / 60W / 170W
- ➔ Resistance 10R ... 50K
- ➔ Adjustable limit switches
- ➔ Program channels (free settings) 1-4

### Product description

High class motorized potentiometer with high power resistor. Easy and fast programmable of each channel. Different cycle time are available for maximum use of potentiometer range.

### Application

Any time controlled application which has to be controlled with micro switches. Usable in motors, locking and emergency backup generators.

### Technical Data

---

Cycle time	(see order code)
Cam	NK
Adjustable limit switches	NK4101/20°
Program channels (free setting)	NK4201/180°
Snap action switch	KS25B4
Mechanical life time	> 20 Mill.
Switching frequency	5 Hz
Contact chatter time	<4 ms
Actuating speed	>10 µm/s
Contact break	0,6 mm
Contact pressure	0,2 N
Temperature range	-40 °C +85 °C
MTBF (IEC 60050)	
Switch	ON/OFF 10 Mio cycle
Mechanical	200'000 hour
Shock resistance	2500m/s <sup>2</sup> , 6ms IEC 68-2-27
Vibrations resistance	200 m/s <sup>2</sup> , 10....2000 Hz IEC 68-2-6
Humidity	40% rh

**MPPS SERIE**



**Microswitch**



Type: KS25B4  
 Function: change over  
 Connection: Cable shoe 2.8x0.55mm  
 Contact material: Silver plated

**Cams**



Type: NK4201.180°  
 Function: double cam  
 Adjustment range: 6 - 180° (free programmable)  
 Material: Grilon T300

**Potentiometer**

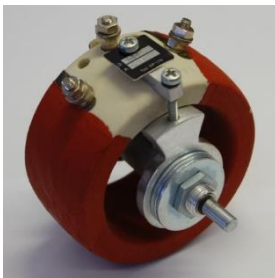

Type: DPM 20 / 60 / 170  
 Resistant: See Order Code  
 Power: 20W / 60W / 170W  
 Turning angle  
 electr./mech. DPM 20 251° / 270°  
 DPM 60 258° / 270°  
 DPM 170 290° / 300°

**Adjusting guideline of NK cams**

To adjust the NK cam use PSN programming Key which is included in the shipment. Put them to the NK cam and turn until you get the right switching point of your switch.

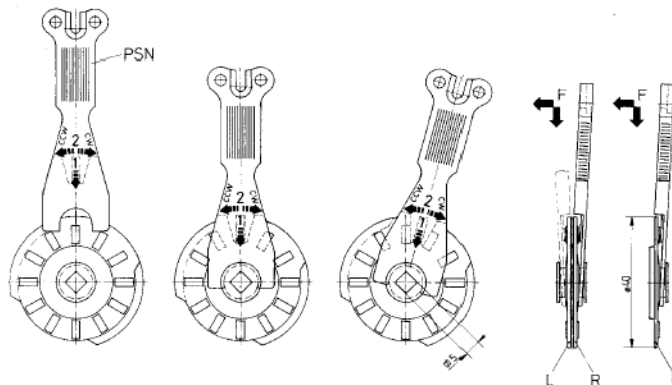

**MPPS SERIE**



Dimension in mm

AC Motor 20 Watt

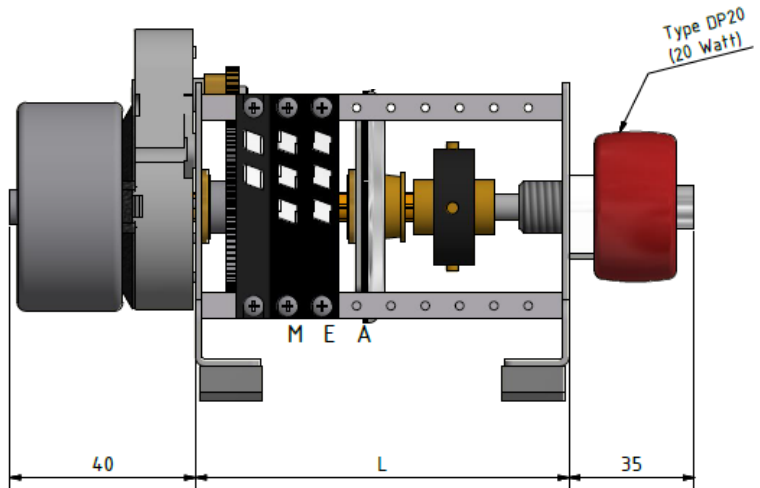
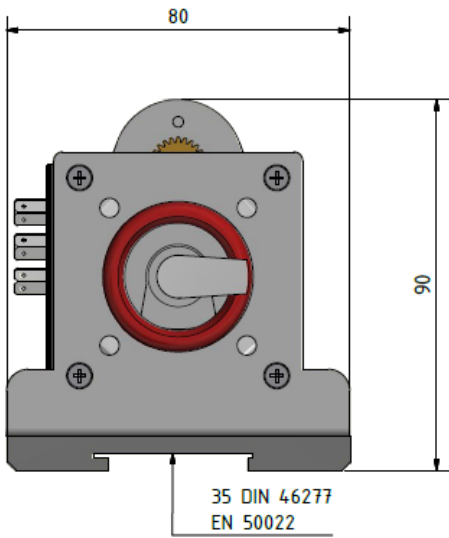

AC Motor 60 Watt

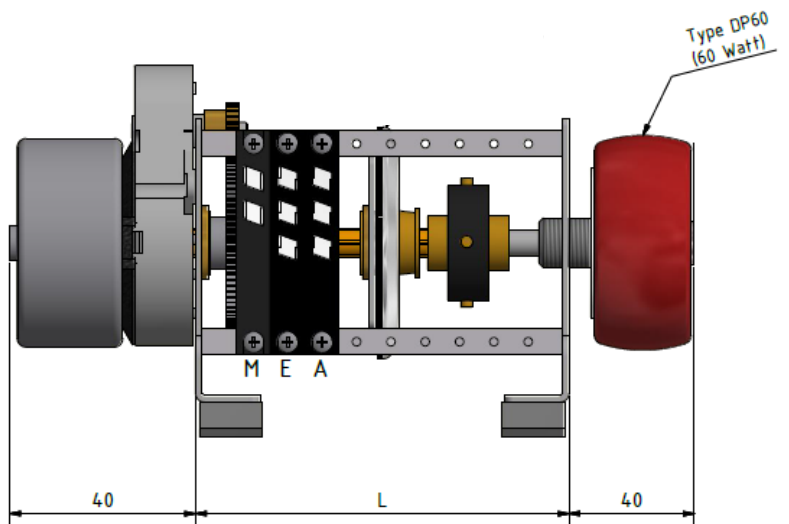
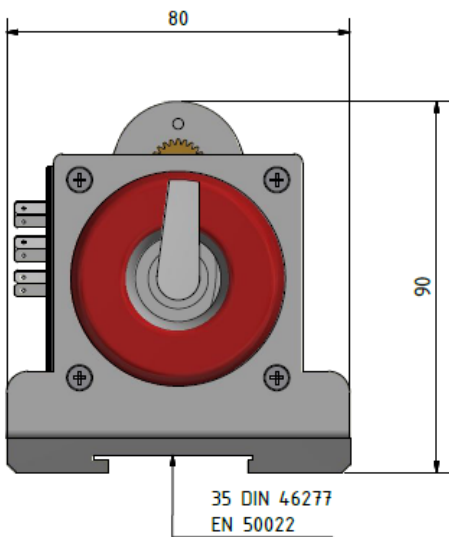

**MPPS SERIE**



AC Motor 170 Watt

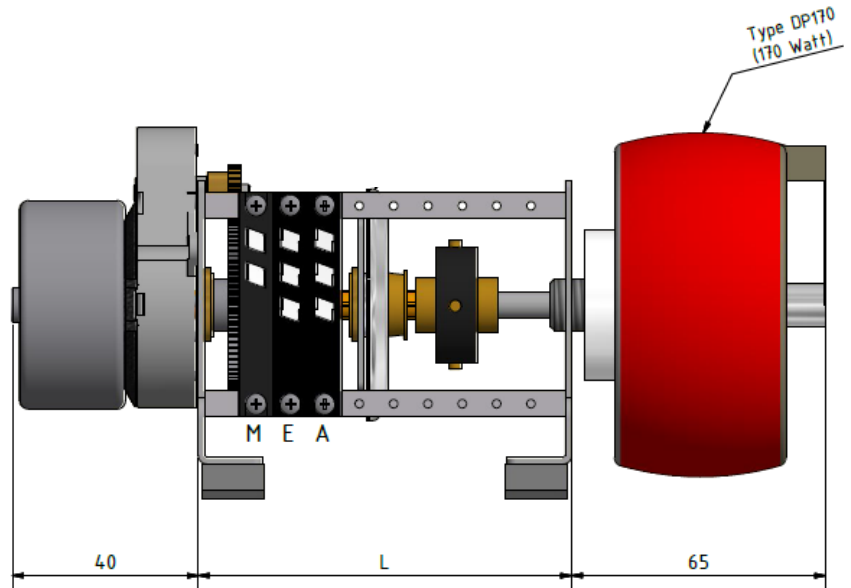
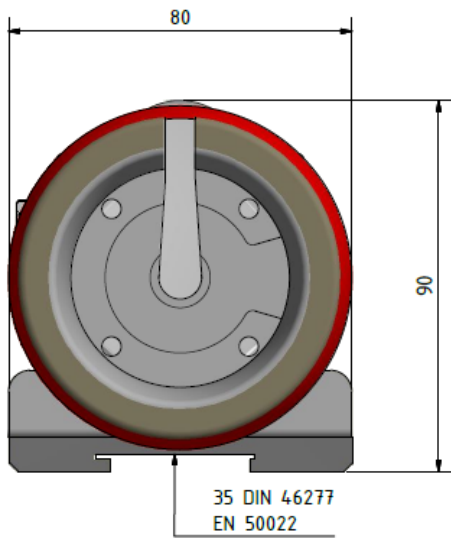

AC Motor 300 Watt

Version mit Doppelpotentiometer  
Version with double potentiometer

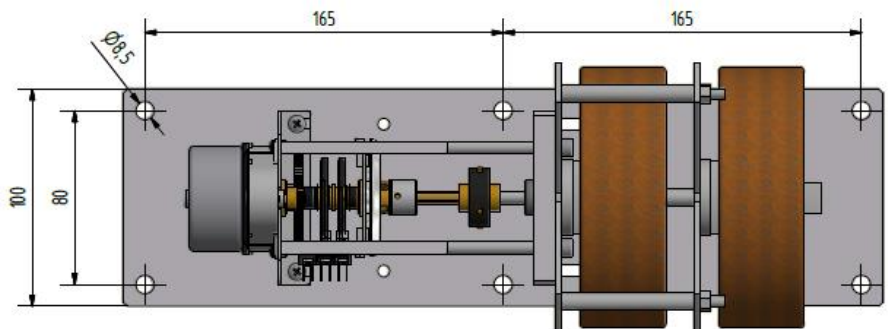
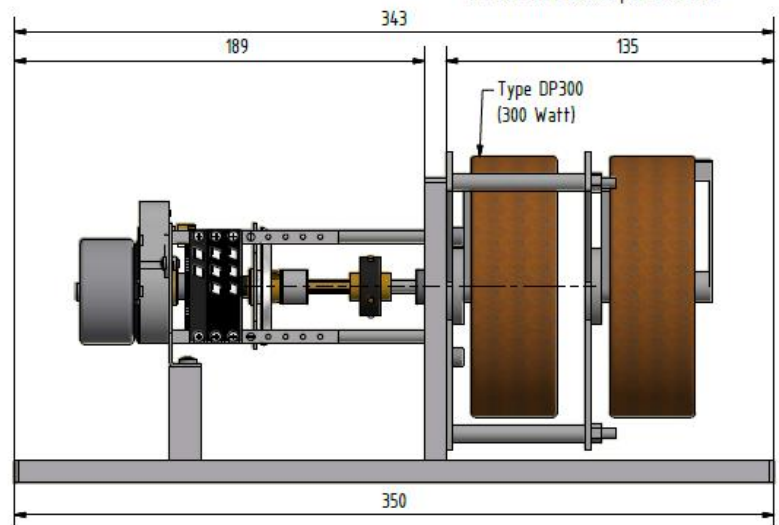
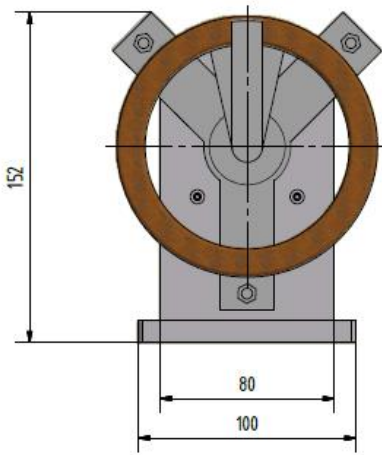

# 1-Turn Motorpotentiometer with high power resistor

## MPPS SERIE



### DC Motor 20 Watt

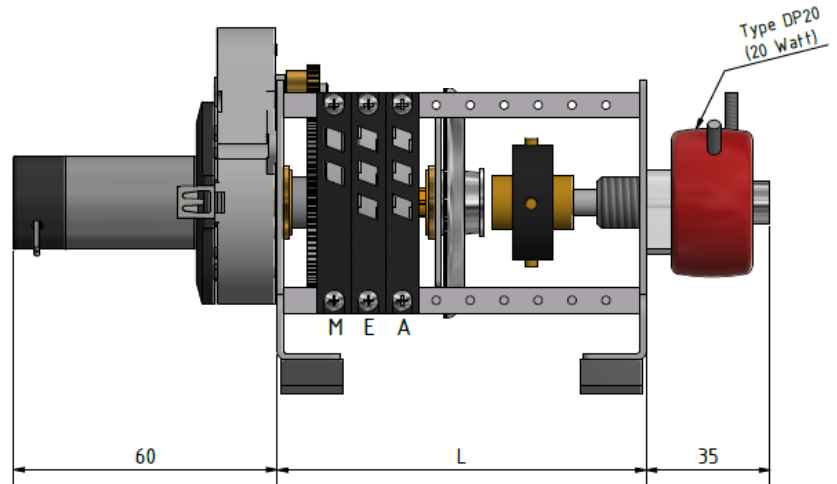
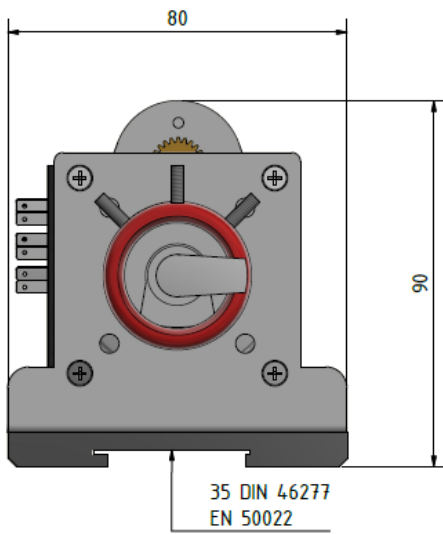

### DC Motor 60 Watt

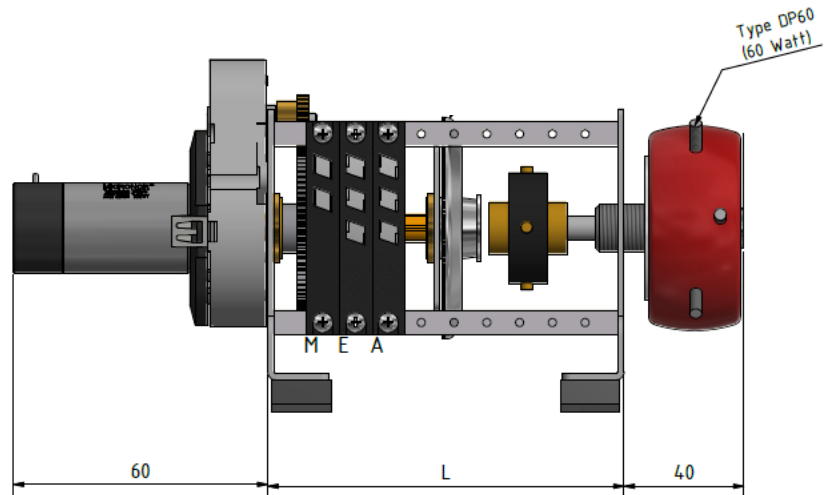
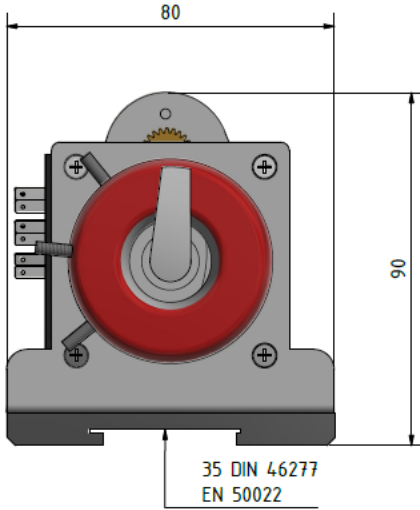

# 1-Turn Motorpotentiometer with high power resistor

## MPPS SERIE



DC Motor 170 Watt

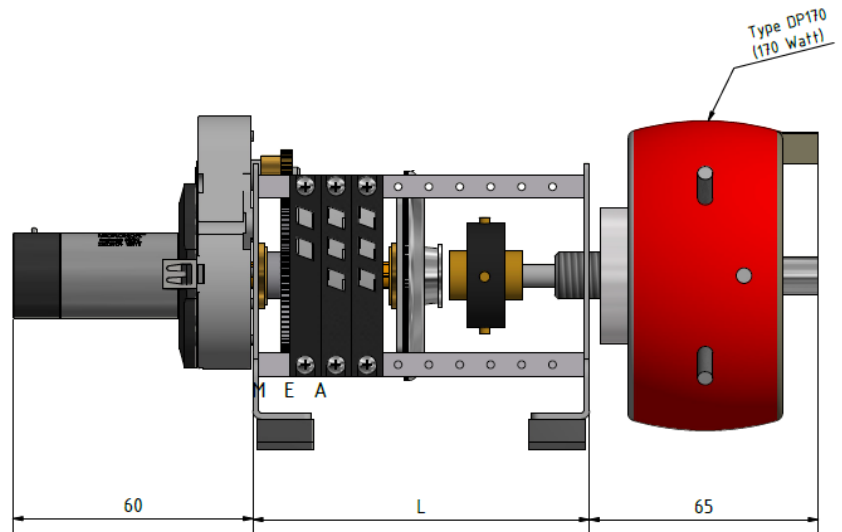
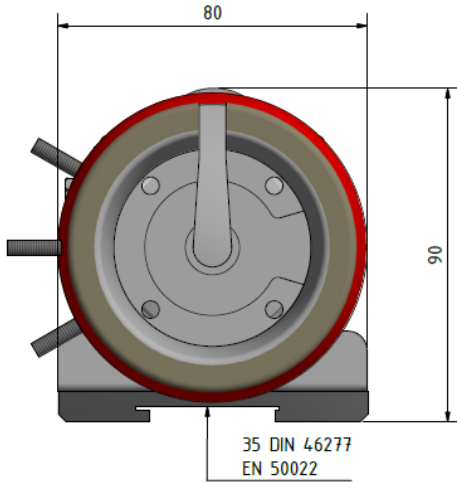

DC Motor 300 Watt

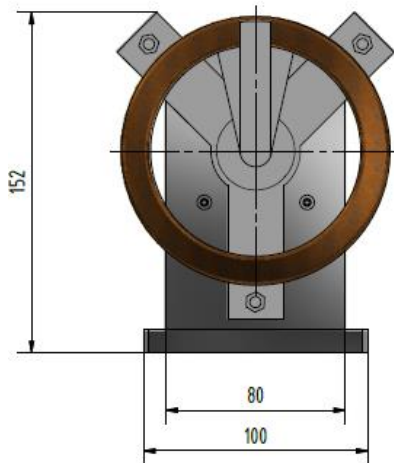

Version mit Doppelpotentiometer  
Version with double potentiometer

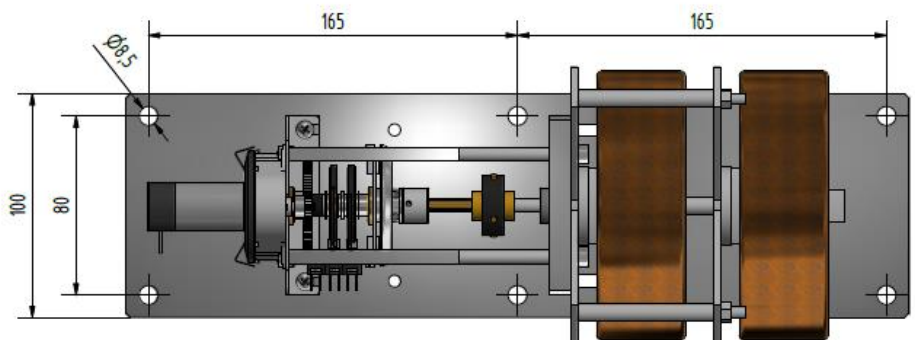
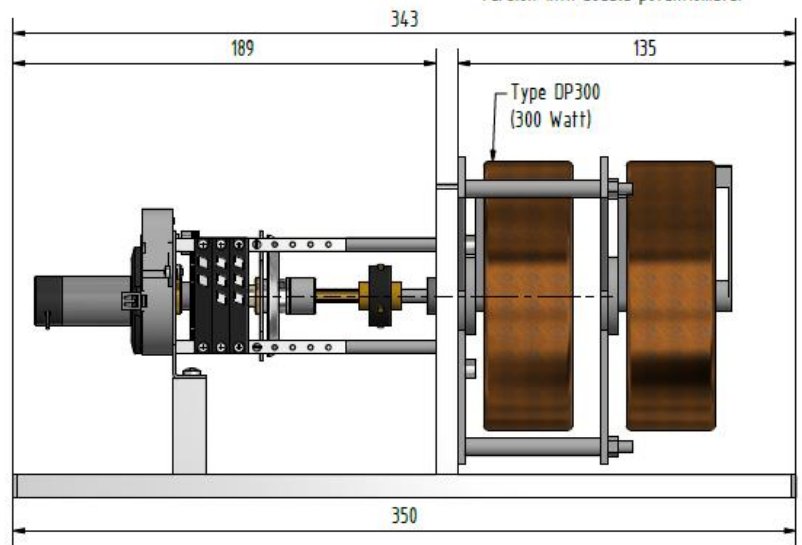

# 1-Turn Motorpotentiometer with high power resistor

## MPPS SERIE



Order code

### MPPS

904 x. x x. x x x

	SIZE
0	Size 0 – 0 switches
2	Size 7 - 2 switches (KS25B4), 79mm length, end switches adjustable (NK4101/20°), 0 user contact free programmable (NK4201), no program key (PSN) not necessary
3	Size 8 - 3 switches (KS25B4), 87mm length, 2 end switches adjustable (NK4101/20°), 1 user contact free programmable (NK4201), 1 program key (PSN)
4	Size 9 - 4 switches (KS25B4), 95mm length, 2 end switches adjustable (NK4101/20°), 2 user contact free programmable (NK4201), 1 program key (PSN)
5	Size 10 - 5 switches (KS25B4), 103mm length, 2 end switches adjustable (NK4101/20°), 3 user contact free programmable (NK4201), 1 program key (PSN)
6	Size 11 - 6 switches (KS25B4), 111mm length, 2 end switches adjustable (NK4101/20°), 4 user contact free programmable (NK4201), 1 program key (PSN)
	CYCLE TIME
1	10 sec
2	15 sec
3	20 sec
4	30 sec
5	45 sec
6	60 sec
7	75 sec
8	90 sec
9	120 sec
	MOTOR POWER (AC/DC) 50Hz
1	C-Motor AC 24V CW
2	C-Motor AC 48V CW / CCW
3	C-Motor AC 110V CW / CCW
4	C-Motor AC 220V CW / CCW
5	G1-Motor DC 24V (+- 0.1) CW / CCW
6	G2-Motor DC 12V (+- 0.1) CW / CCW
	60Hz Frequency on request
	POWER OF THE POTENTIOMETER DPM
0	None
1	DP1 wire wound potentiometer 2 Watt
2	DPM20 wire wound potentiometer 20 Watt
3	DPM60 wire wound potentiometer 60 Watt
4	DPM170 wire wound potentiometer 170 Watt
	RESISTANCE POTENTIOMETER DPM
0	None
1	500Ohm
2	1kOhm
3	2kOhm
4	5kOhm
5	10kOhm
	STOP AND CONTROL UNIT FOR DC-MOTORS
0	None
1	PRSG.2 Control unit Stop and Switch E and A
2	PSG.2 stopper unit for DC Motors - two switches
3	PRSG.3 Control unit Stop and Switch E and A + 1
4	PSG.3 stopper unit for DC Motors - three switches
5	MR265 4-20mA Sensor output 2 wire
6	MR265 4-20mA Current interface 4 wire, GND Power and two Sensor
7	MR267 4-20mA
8	MR267 0-10V



**Do you have any Questions ?** Phone: +41 (0)44 843 40 20 or Mail: [sales@micronor.ch](mailto:sales@micronor.ch)